



STARHOTELS®

PREMIUM

Du Parc

PARMA

Du Parc

PARMA



Art Nouveau Elegance

Welcome to The Golden Age of Travel. The Du Parc is rich in Art Nouveau influences, from the modern façade with its large windows and striking symmetry to the classic interior with its Liberty-style fabrics and original antiques. Close to the old town, with direct access to the expansive Parco Ducale, the Du Parc is more than just a pretty face. There are ten meeting rooms, with capacity for 600 delegates and two renowned restaurants: Canova and Aiglon. Whether business, pleasure, or a bit of both, it's an experience to savor.

Du Parc

PARMA



Location

Just a few steps away from the historical center and with a private entrance to the magnificent Parco Ducale

Distances

Railway station: Km 0,5

Highway: Km 3

Airport: Giuseppe Verdi Km 5

Fairgrounds: Km 4

Viale Piacenza, 12/c - 43100 Parma - ITALY

T +39 0521 292929 F +39 0521 292828

duparc.pr@starhotels.it

starhotels.com

Du Parc

PARMA

Restaurant & Bar

Sample two of the city's finest restaurants: Canova and Aiglou. The Canova features sublime regional and seasonal cuisine, as well as international favorites. The Aiglou can seat up to 200 diners for a spectacular banquet.

Our dining experience is based on three guidelines: traditional Parma-style cuisine, food by Eataly and recipes from the Ceci family, who have been leading the way in fine dining in Parma for three generations.



Du Parc

PARMA



169 Rooms

89 Classic
60 Superior
14 Junior Suite
6 Suite

Liberty-style lines, abstract patterns and tapestry, sumptuous fabrics and furnishings, our 169 rooms and suites seamlessly blend the classic and the contemporary.



Du Parc

PARMA



Meetings & Events

Meeting rooms: 10

Capacity (theatre style): 600 max

The hotel offers ten luxurious conference rooms for up to 600 people, all equipped with the latest technology and supported by an experienced events team.



Du Parc

PARMA

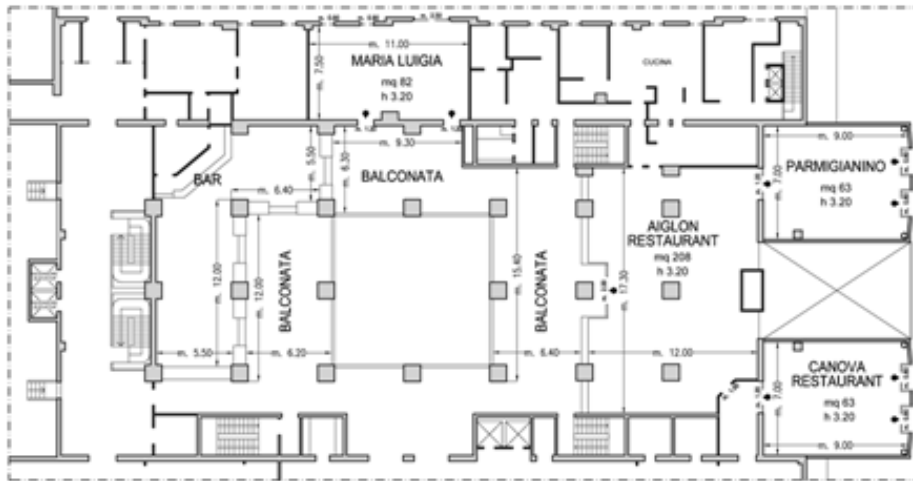

Piano Terra / Ground Floor



Piano -1 / Basement

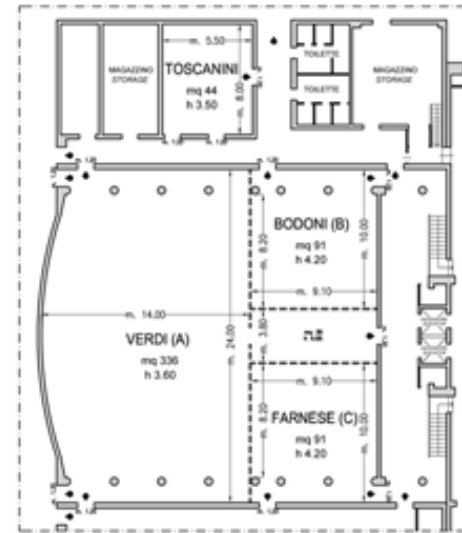

Piano -2 / Floor -2

- ◆ Uscite di sicurezza / Emergency Exits
- - - Finestre / Windows
- ===== Paredi mobili / Modular Walls
- Colonne / Columns

10 meeting room fino a 600 persone/ 10 meeting rooms up to 600 seats

Du Parc

PARMA

Sale riunioni Meeting rooms	Area mq Area sq.ft.	Lung. x larg. mt. L x W ft.	altezza mt. height ft.	teatro theatre	banchi scuola class room	Tavolo unico ferro di cavallo conference table/ U-shape	cabaret style^	cocktail reception	banchetto banquet
Verdi (A)	336 3615,36	14,00x24,00 45,93x78,74	3,6 11,81	300	120	75	108	350	250
Bodoni (B)	91 979,16	10,00x9,10 32,81x29,86	4,2 13,78	70	40	30	24	90	40
Farnese (C)	91 979,16	10,00x9,10 32,81x29,86	4,2 13,78	70	40	30	24	90	40
(A+B+C)	564 6070,82	23,50x24,00 77,10x78,74	3,604,20 11,81-13,78	600	250	140	210	500	450
Toscanini	44 473,44	8,00x5,50 26,25x18,04	3,5 11,48	35	10	15	12	-	-
Maria Luigia*	82 882,32	11,00x7,50 36,09x24,61	3,2 10,5	45	25	20	24	50	-
Stendhal*	60 645,83	6,50x9,20 21,33x30,18	2,7 8,86	35	18	18	12	-	-
Rossini*	76 818,05	12,80x6,00 41,99x19,68	2,7 8,86	45	25	20	18	50	-
Puccini*	84 904,16	14,00x6,00 45,93x19,68	2,7 8,86	65	30	25	24	-	-
Donizetti	46 494,96	8,50x5,50 27,89x18,04	2,7 8,86	35	15	15	12	-	-
Foyer Congressi	120 1291,2	10,00x12,00 32,81x39,37	-	-	-	-	-	120	-
La Piazzetta	115 1237,84	10,50x11,00 34,44x36,08	-	-	-	-	-	110	-
Aiglon + Parmigianino + Canova + Balconate	570 6135,4	22,00x26,00 72,18x85,30	-	-	-	-	-	500	450
Canova Restaurant *	63 677,88	7,00x9,00 22,97x29,53	-	-	-	-	-	-	50
Aiglon Restaurant	208 2238,92	17,30x12,00 56,74x39,36	-	-	-	-	-	250	180
Parmigianino	63 677,88	7,00x9,00 22,97x29,53	-	-	-	-	-	-	50

* Luce naturale / Daylight

^ Cabaret style: tavoli diametro cm 180, fino a 6 pax cad / Diameter tables cm 180, up to 6 pax each